

TECHNICAL MANUAL

COCOON BUILDING TECHNOLOGIES

9922, 78 Avenue
Edmonton, Alberta T6E 1N5
780.932.2381
info@magwall.com

ABOVE GRADE DETAILS

TABLE OF CONTENTS

- A. PANEL CONNECTION DETAILS
 - A1. SIP SPLINE CONNECTION
 - A2. TJI PANEL FASTENING

- B. ROOF DETAILS
 - B1-3. RIDGE CONNECTION
 - B4. ROOF-RIDGE INTERSECTION
 - B5. RIDGE SECTION
 - B6. ROOF CONNECTION W/ BRACKET
 - B7. SLOPED ROOF BEAM CONNECTION

- C. WALL/FLOOR DETAILS
 - C1. WALL/FLOOR CROSS SECTION
 - C2. SIP CONCRETE SLAB
 - C3. FLOATING CONCRETE SLAB

- D. EAVE DETAILS
 - D1. EAVE CONNECTION DETAIL
 - D2. EAVE CONNECTION - OPTION

- E. MISCELLANEOUS DETAILS
 - E1. SIP SPLINE/BEAM SUPPORT CONNECTION

PANEL CONNECTION DETAILS

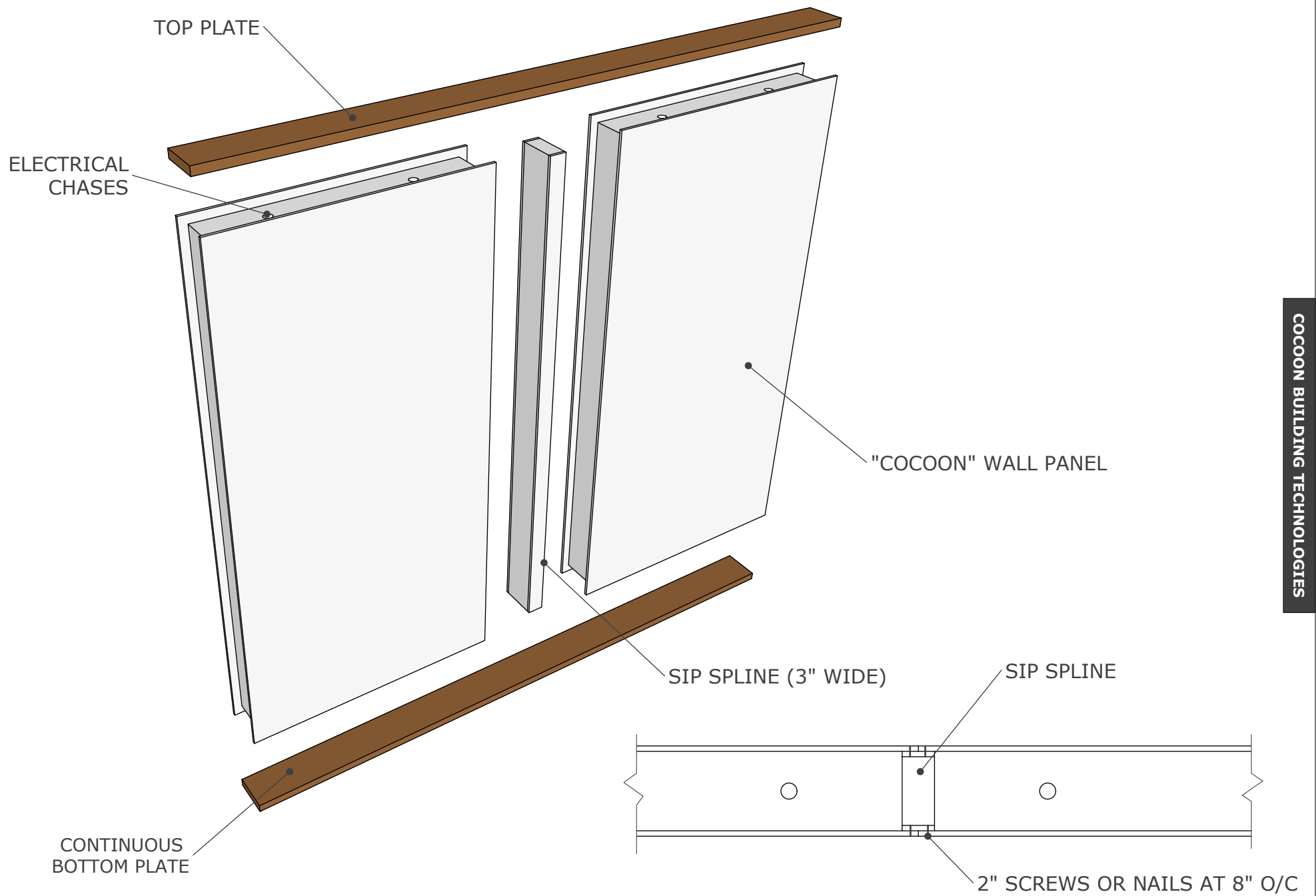

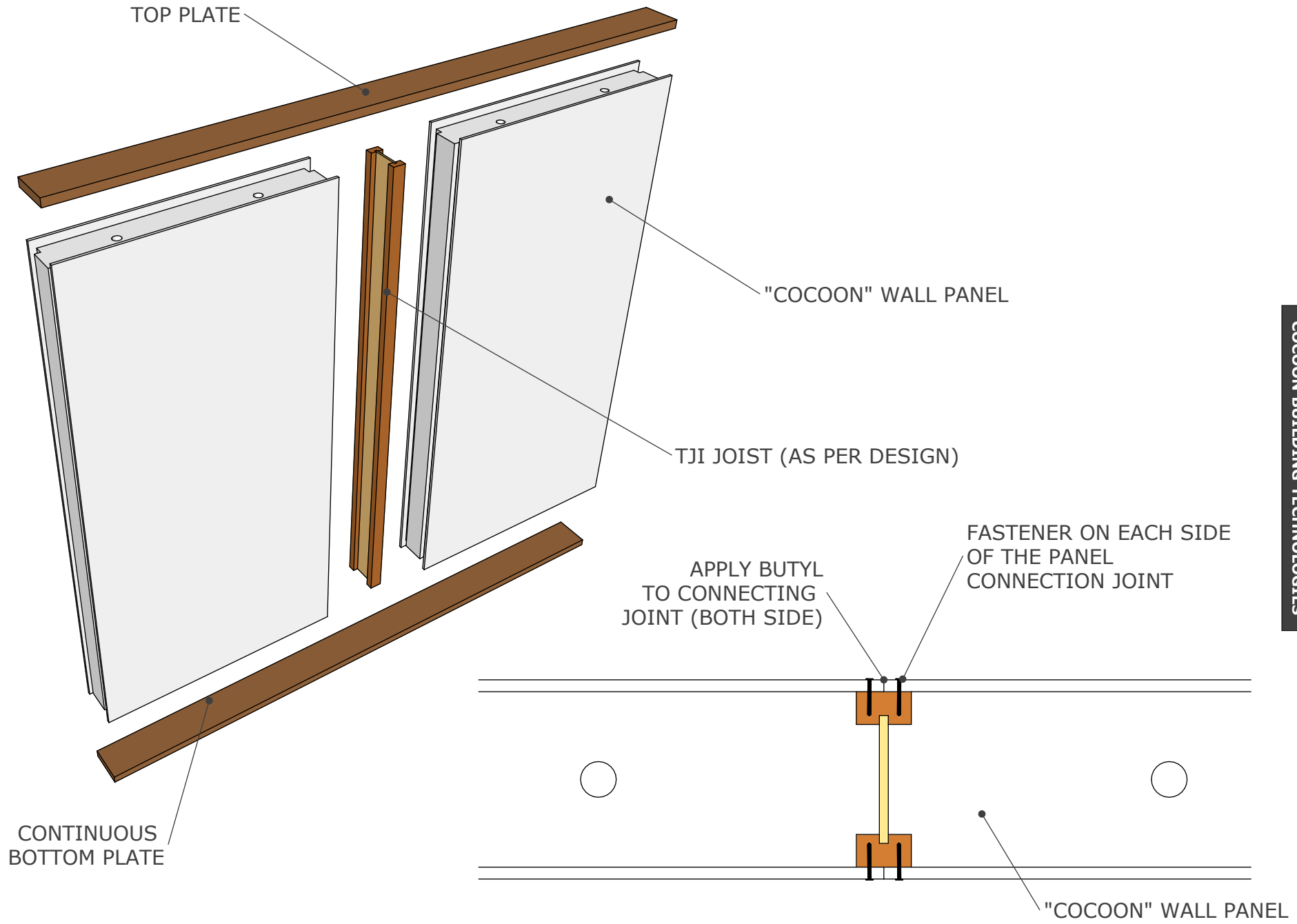

ROOF DETAILS

1 1/2" X 9 1/2" RIMBOARD
OR EQUAL

PANEL SCREWS
AT 12" o/c

PANEL SCREWS
AT 12" o/c

BEVELED WOOD BLOCKING
CONTINUOUS

10 1/2" "COCOON" PANEL

RIDGE BEAM

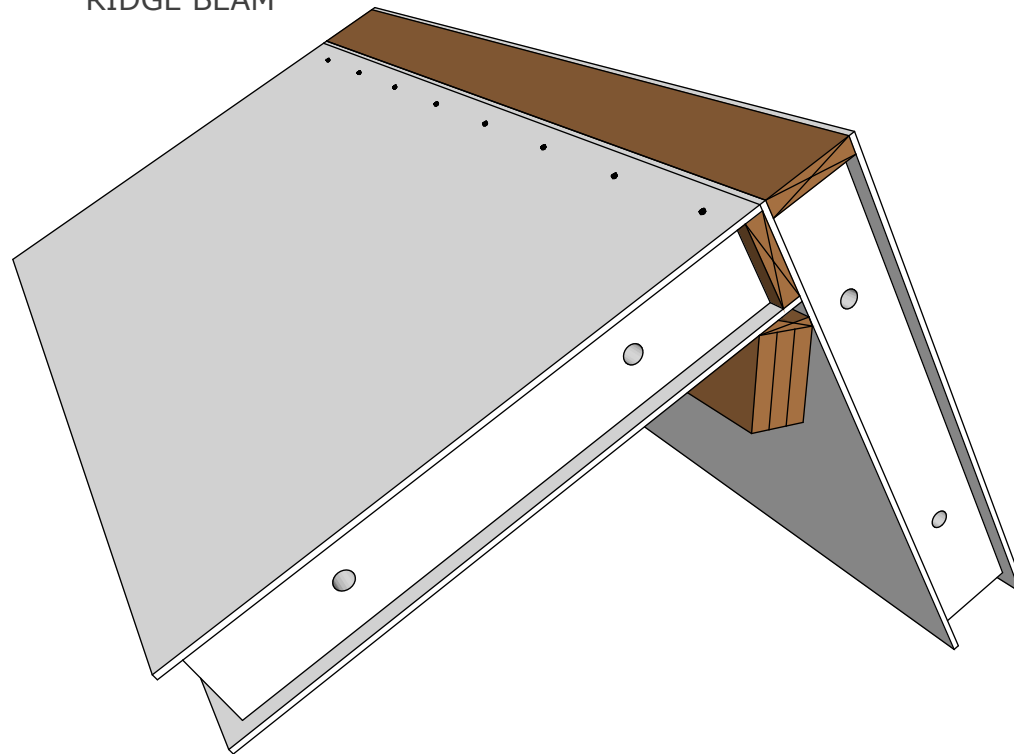

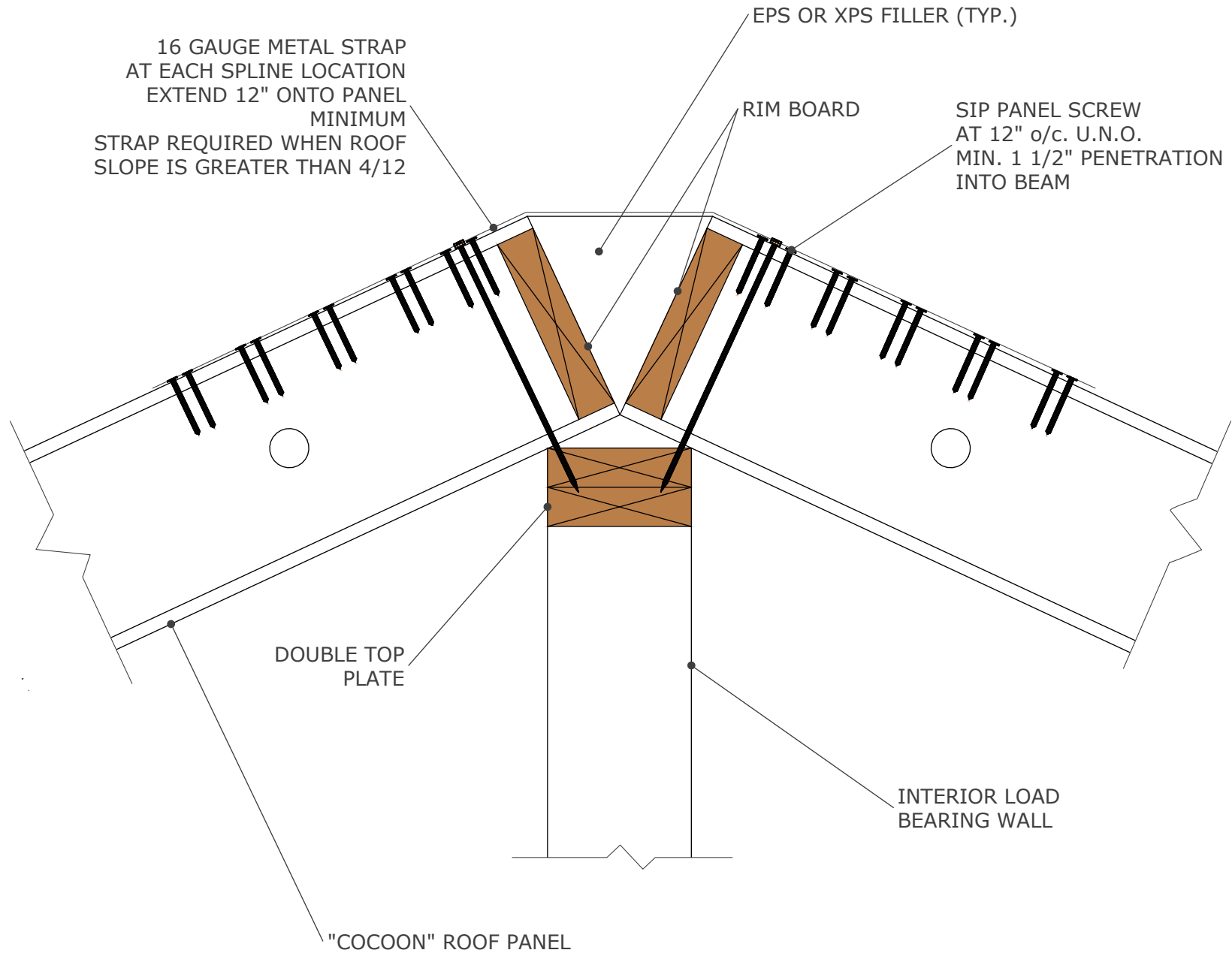

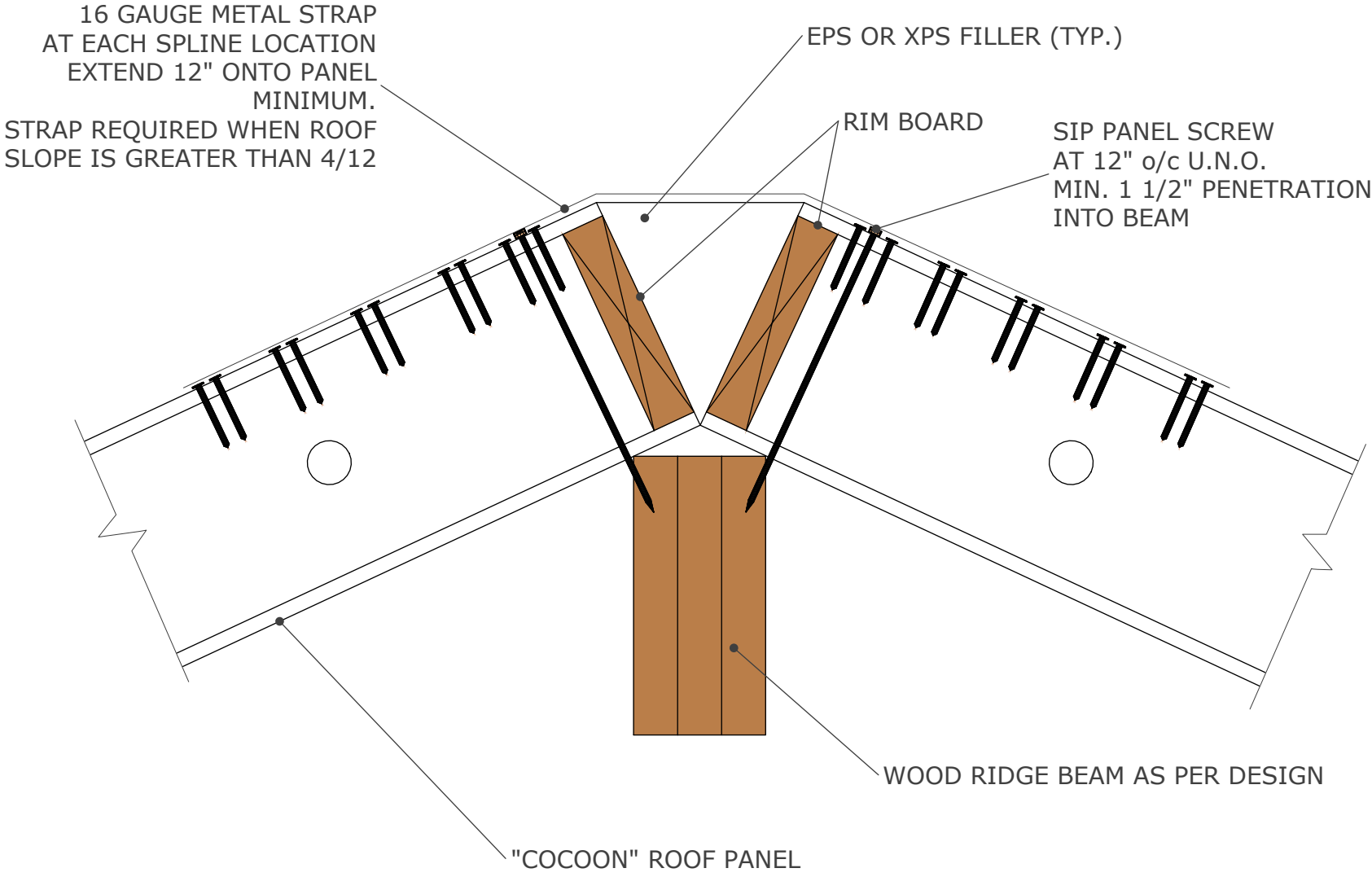

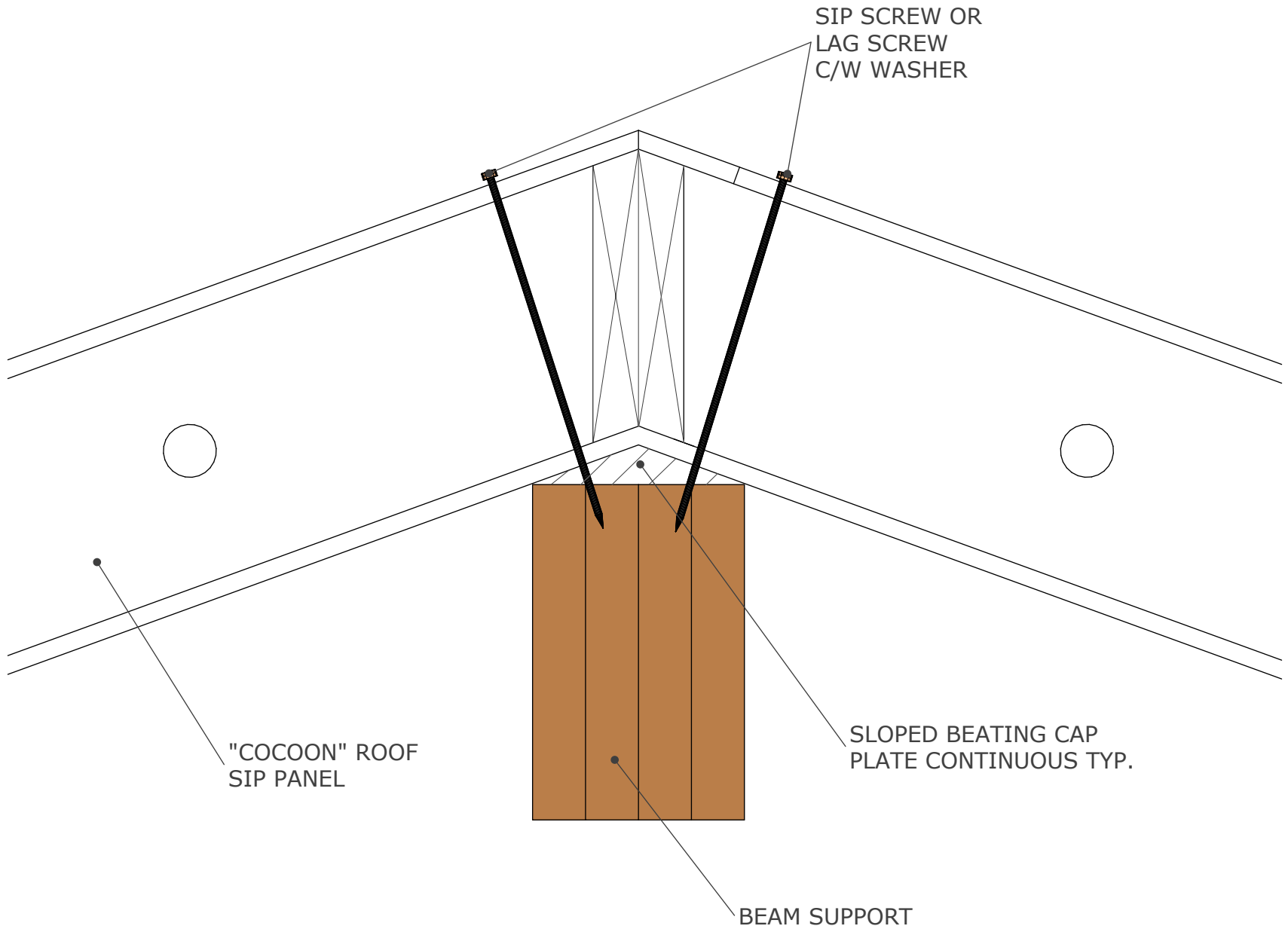

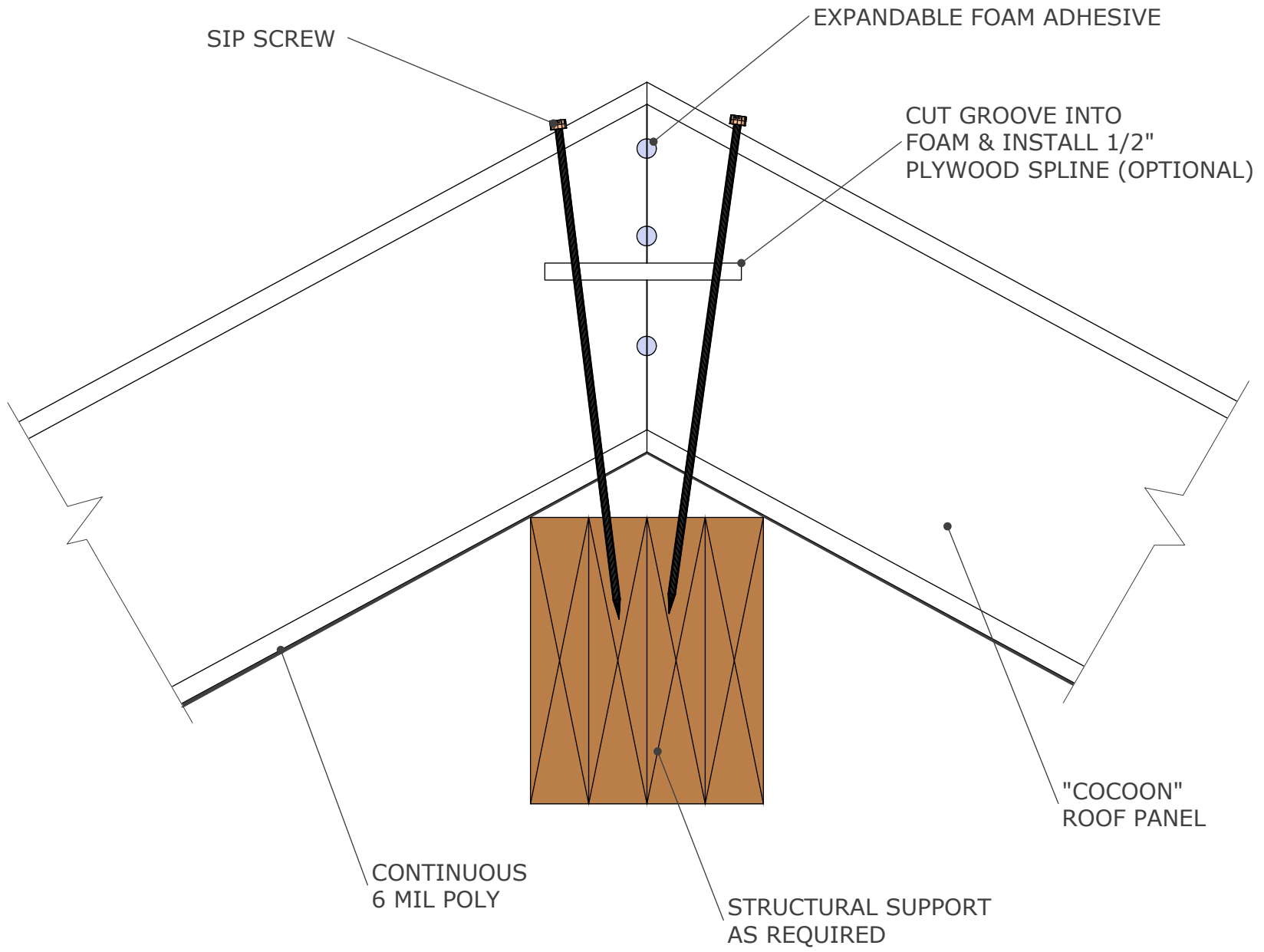

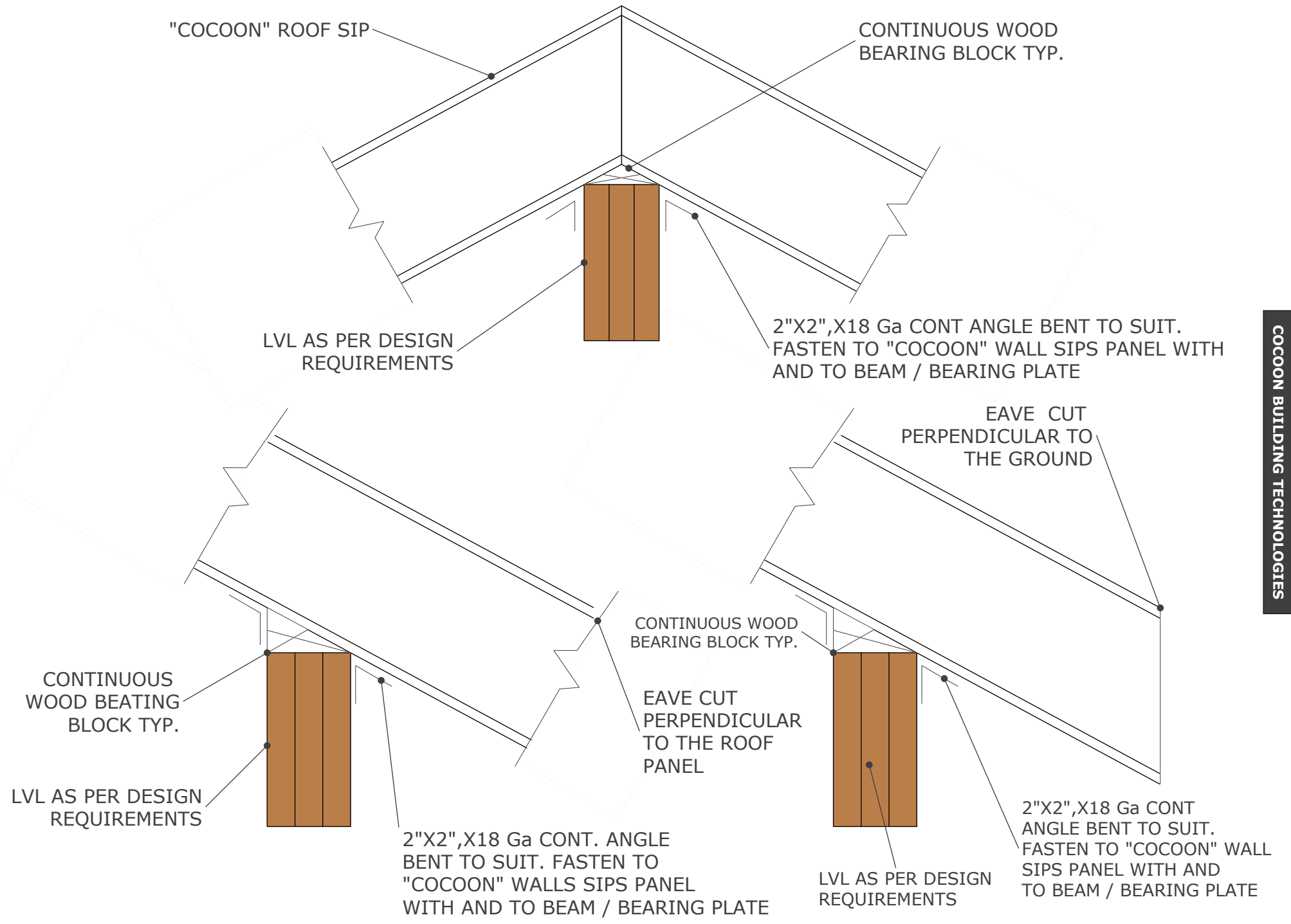

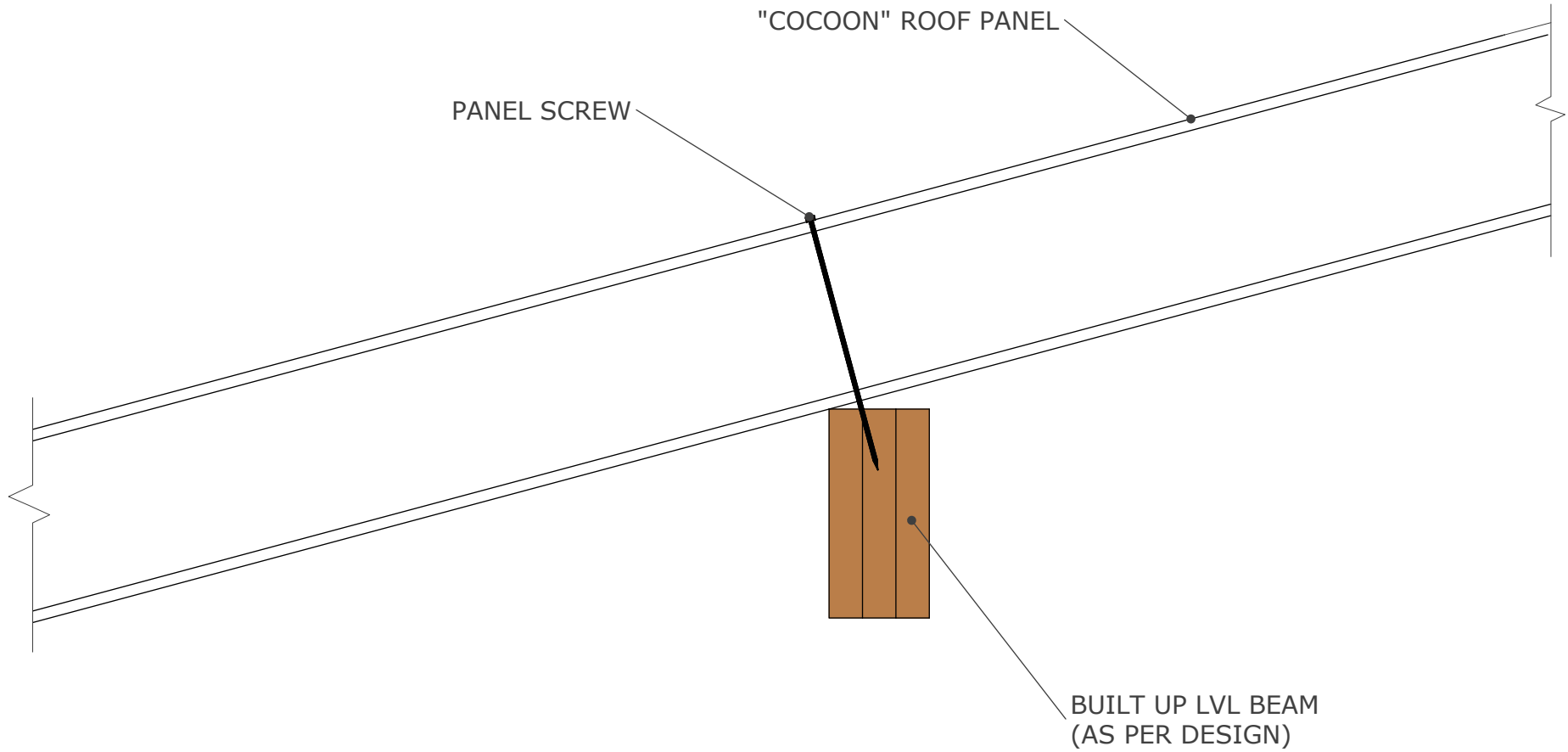

WALL/FLOOR DETAILS

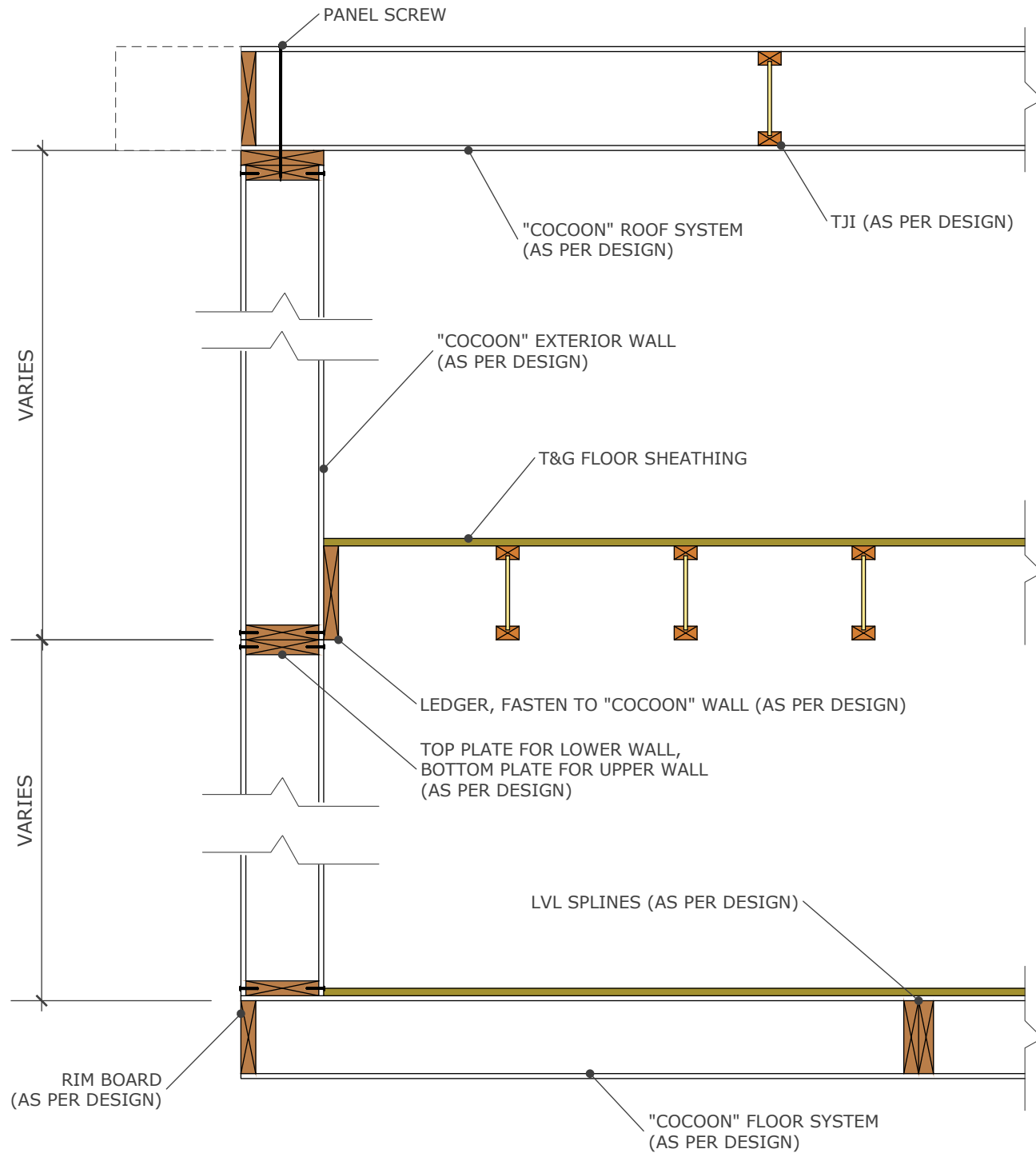

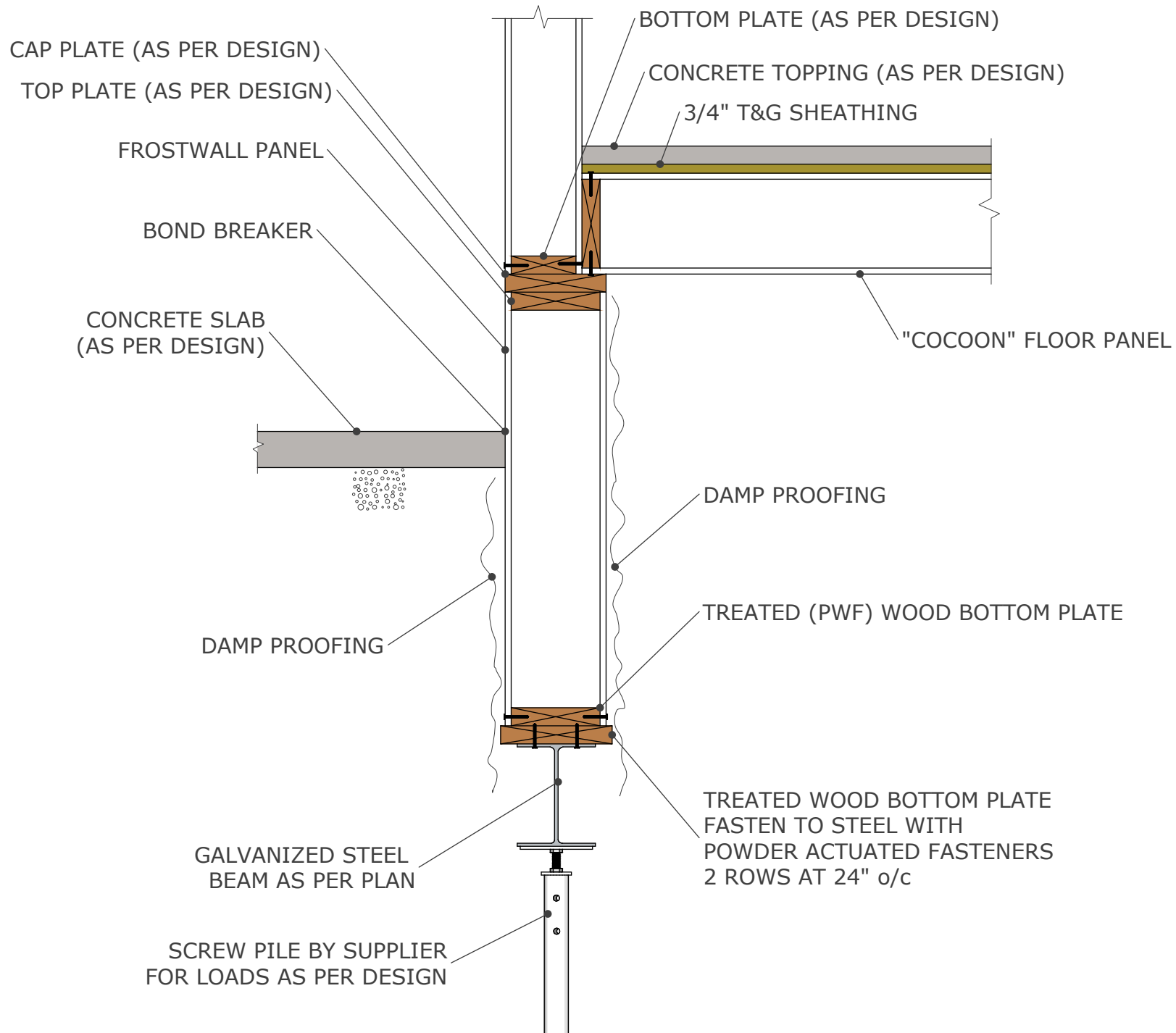

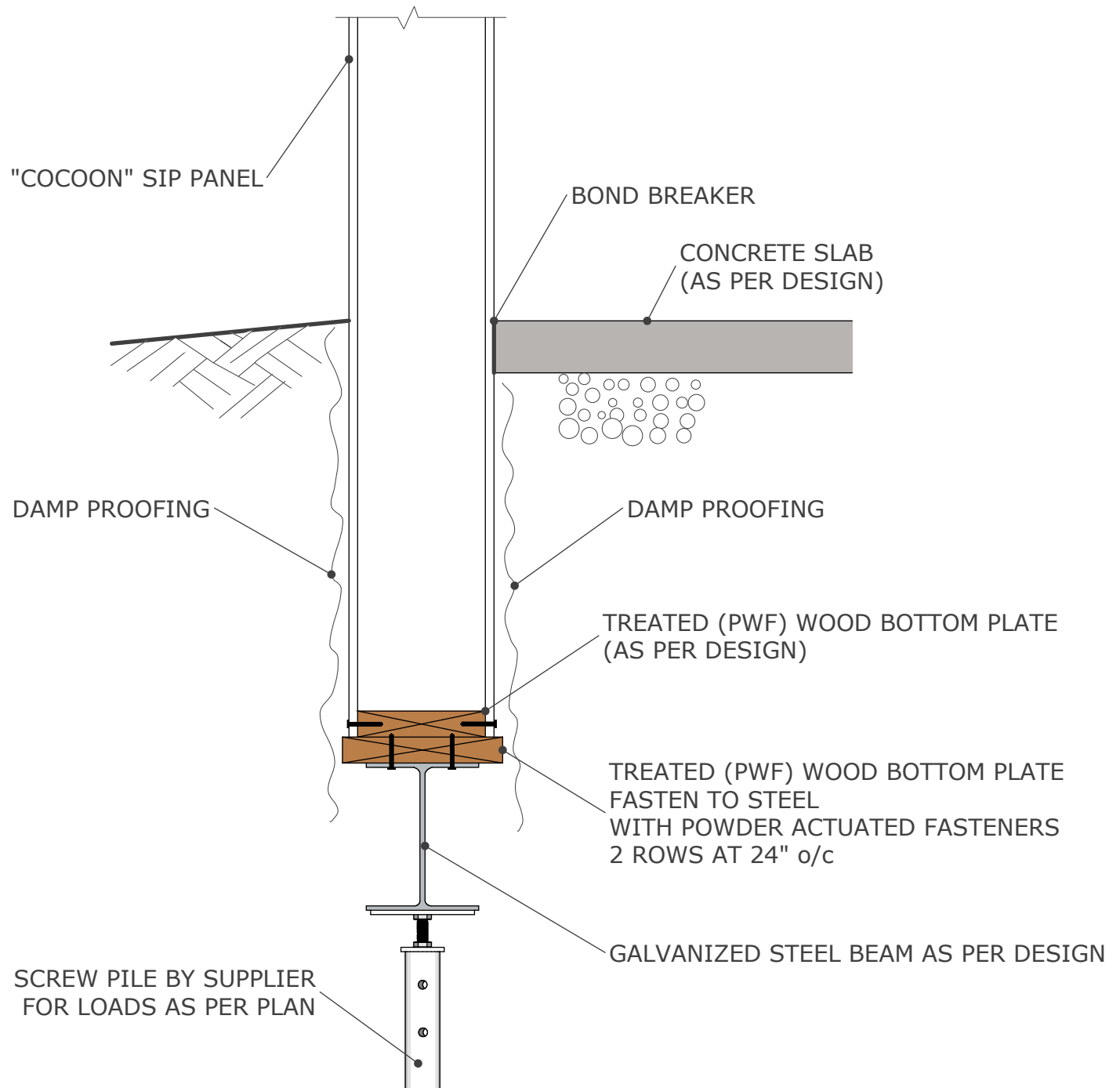

EAVE DETAILS

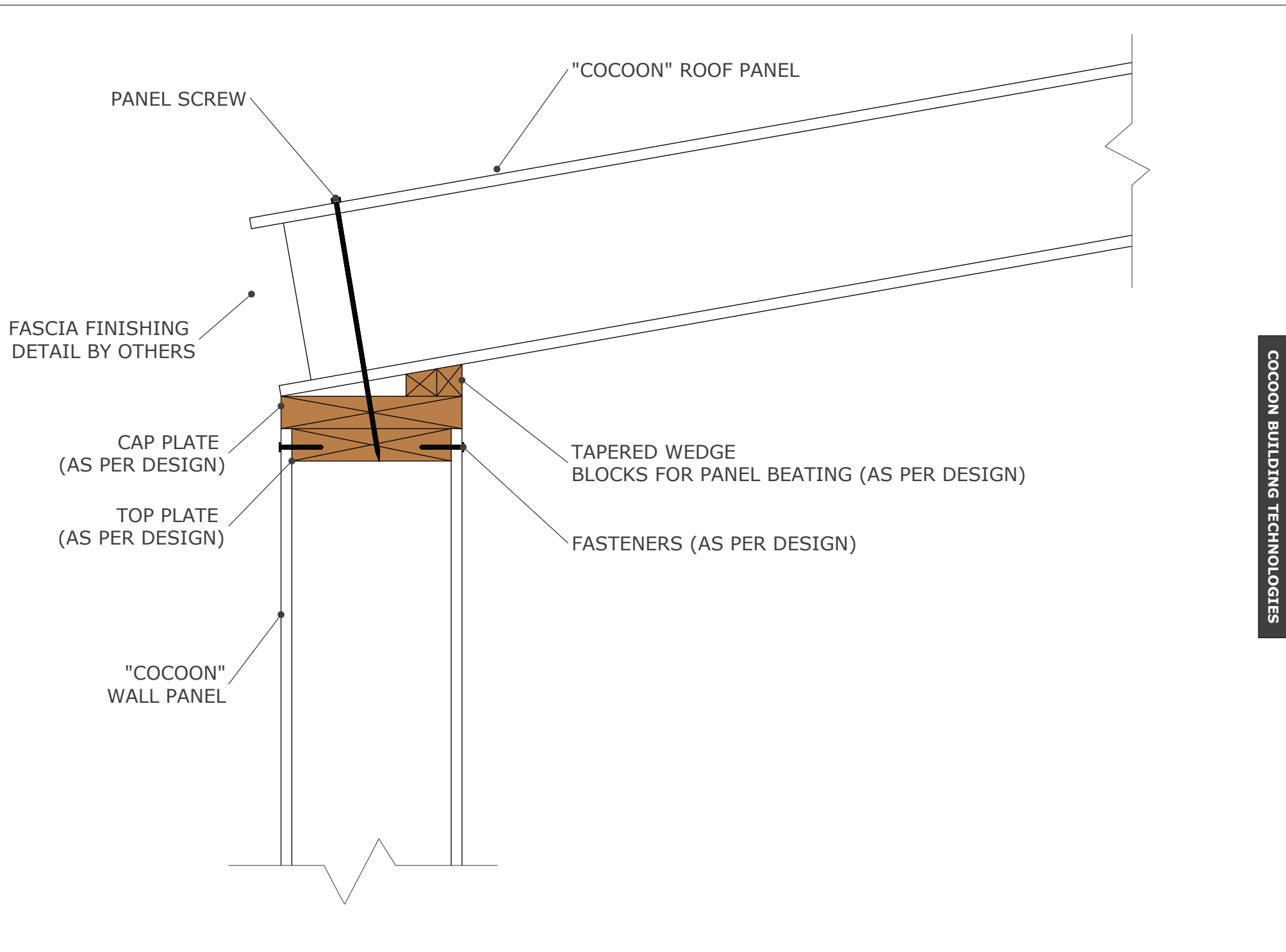

MAXIMUM 6/12 SLOPE WITH THIS DETAIL

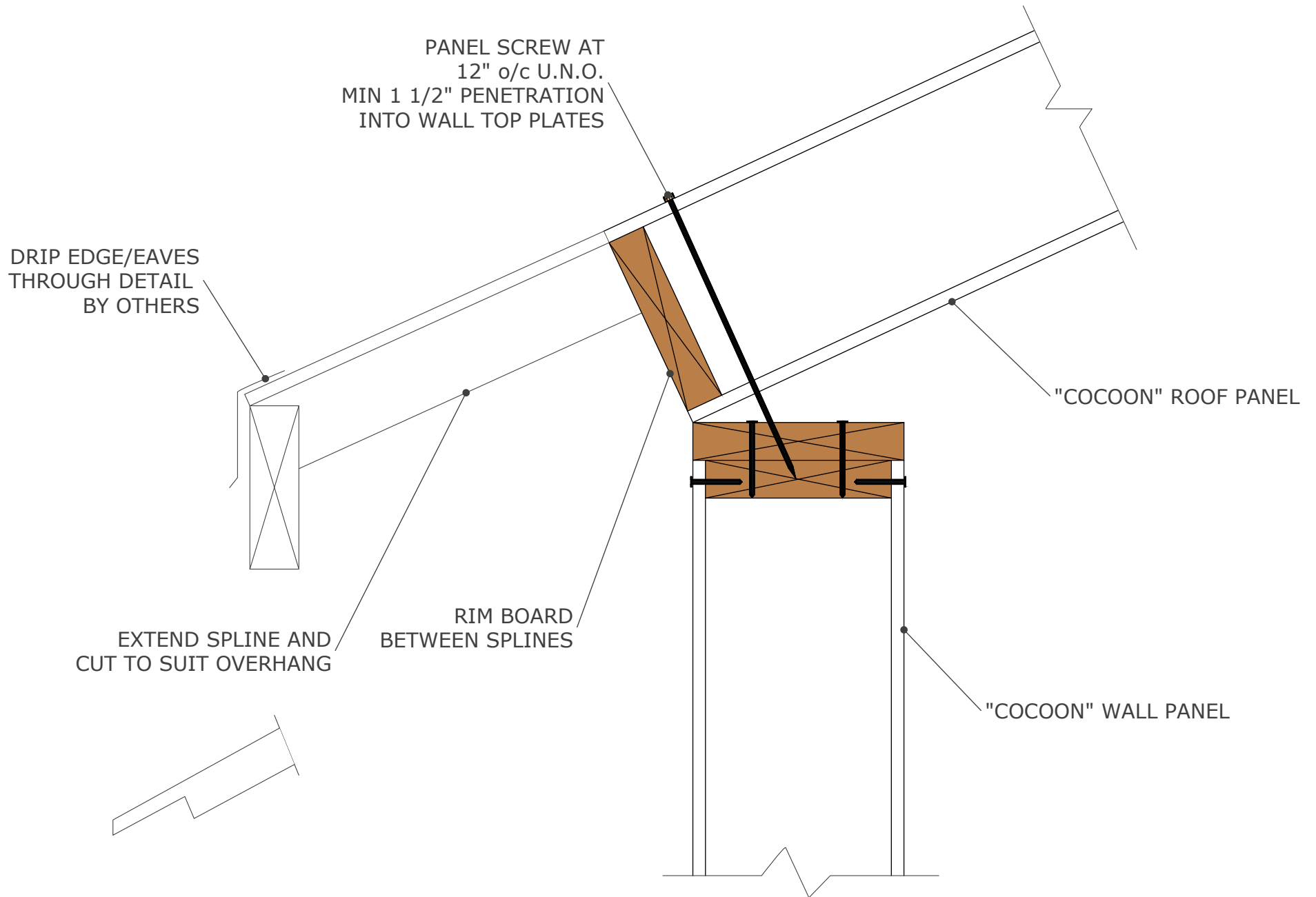

MISCELLANEOUS DETAILS

